

THE  
KNIGHTSBRIDGE  
ESTATE.

---

Retail  
Availability  
3 Sloane Street



# 3

## SLOANE STREET

A best in class flagship store, set across four floors in a prominent Sloane Street location.

- 11,990 sq ft / 1,113.9 sq m
- Basement, Ground, First and Second Floors
- Ground Floor ceiling height - 4.13 metres
- Dedicated service yard and goods lift
- Integrated servicing

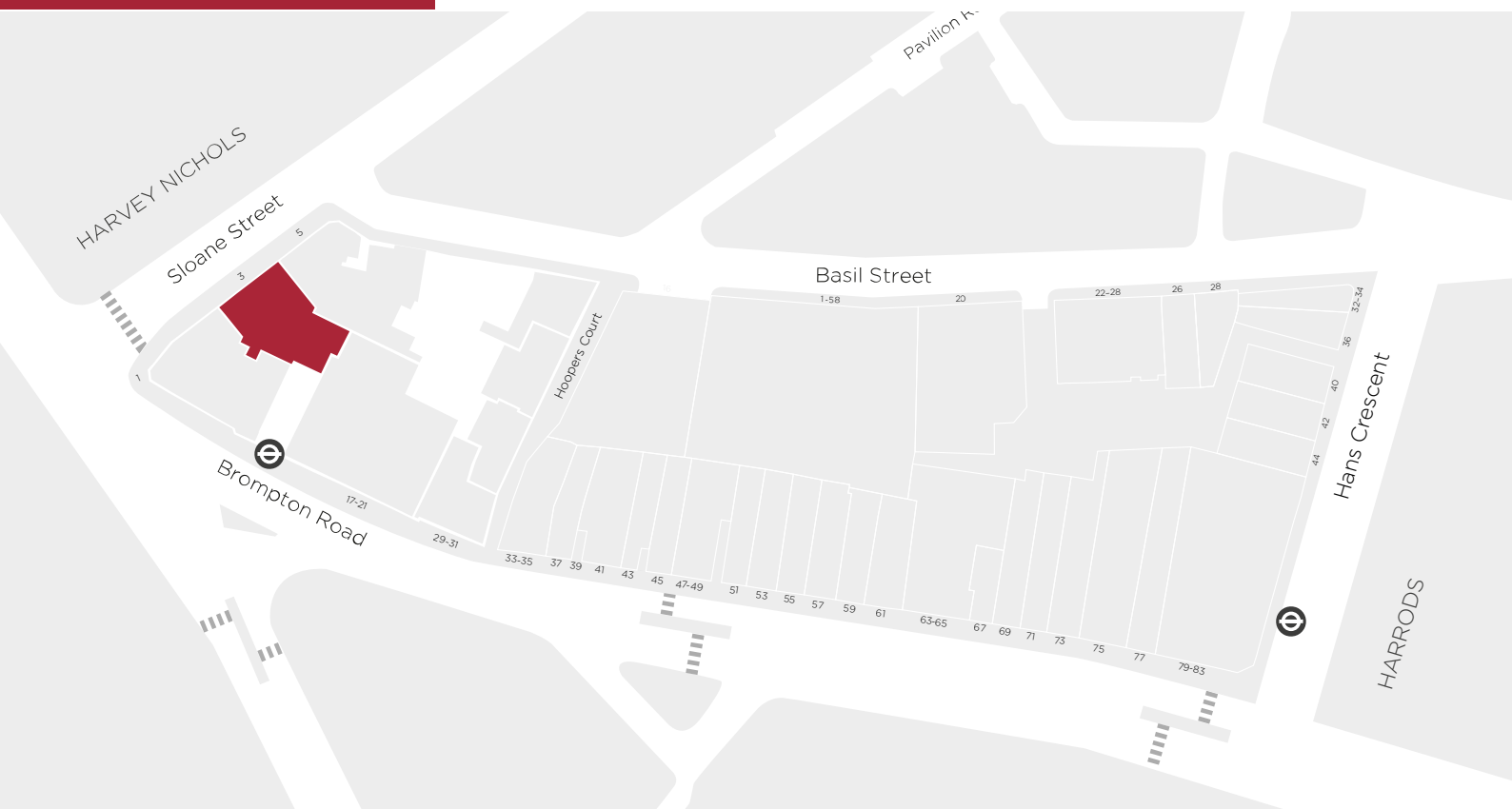

# 3 Sloane Street

\*All floorplans and CGIs are indicative only and subject to design development

TOTAL AREA  
11,990 sq ft / 1,113.9 sq m

SECOND FLOOR  
2,821 sq ft / 262.1 sq m

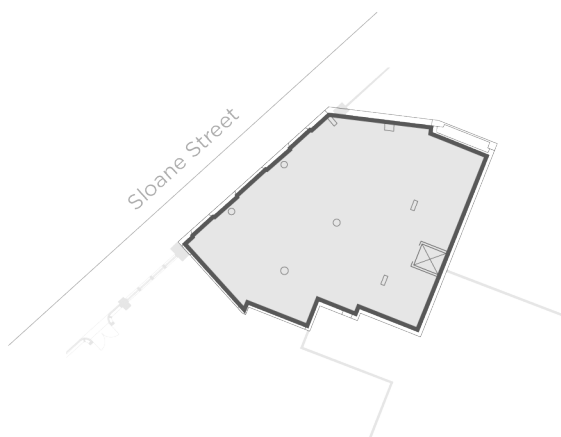

FIRST FLOOR  
3,616 sq ft / 335.9 sq m

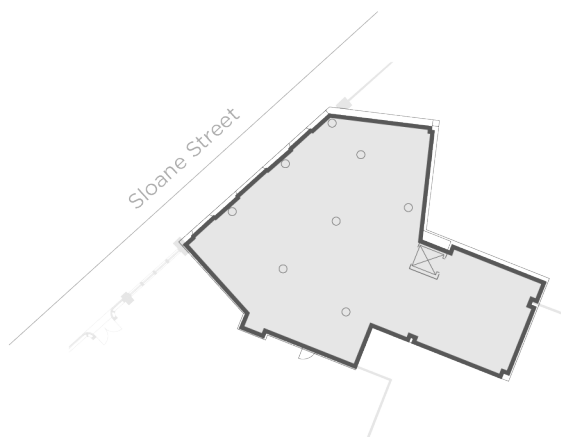

GROUND FLOOR  
2,832 sq ft / 263.1 sq m

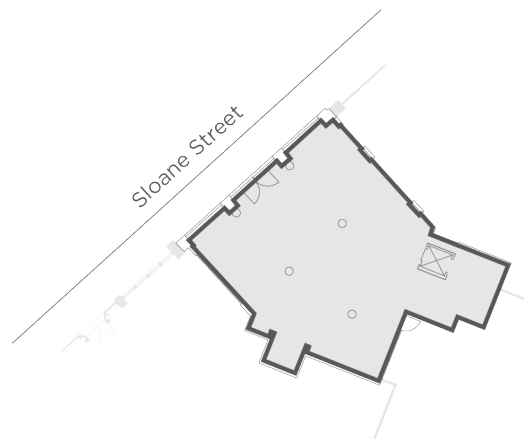

BASEMENT  
2,721 sq ft / 252.8 sq m

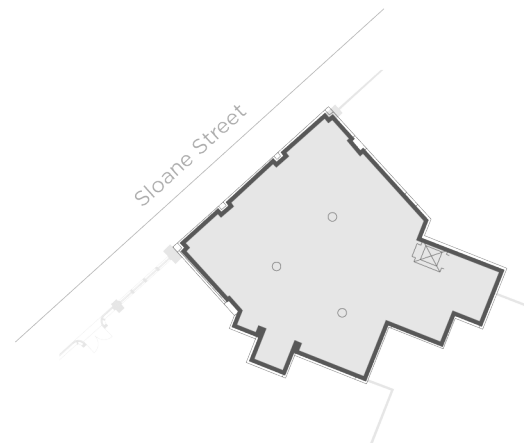



# Get in touch

Please contact us to enquire  
about the retail unit.

Owned by

**COLAVAN**<sup>®</sup>

**CUSHMAN &  
WAKEFIELD**

**Duncan Gilliard**  
[Duncan.Gilliard@cushwake.com](mailto:Duncan.Gilliard@cushwake.com)  
07881 501164

Asset & Development Manager

**Chelsfield**

**Colliers**

**Erin Mcdonald**  
[Erin.Mcdonald@colliers.com](mailto:Erin.Mcdonald@colliers.com)  
07714 145967