

THE KNIGHTSBRIDGE ESTATE.

Retail
Availability
3 Sloane Street



3

**SLOANE
STREET**

A best in class flagship store, set across four floors in a prominent Sloane Street location.

- 11,990 sq ft / 1,113.9 sq m
- Basement, Ground, First and Second Floors
- Ground Floor ceiling height – 4.13 metres
- Dedicated service yard and goods lift
- Integrated servicing

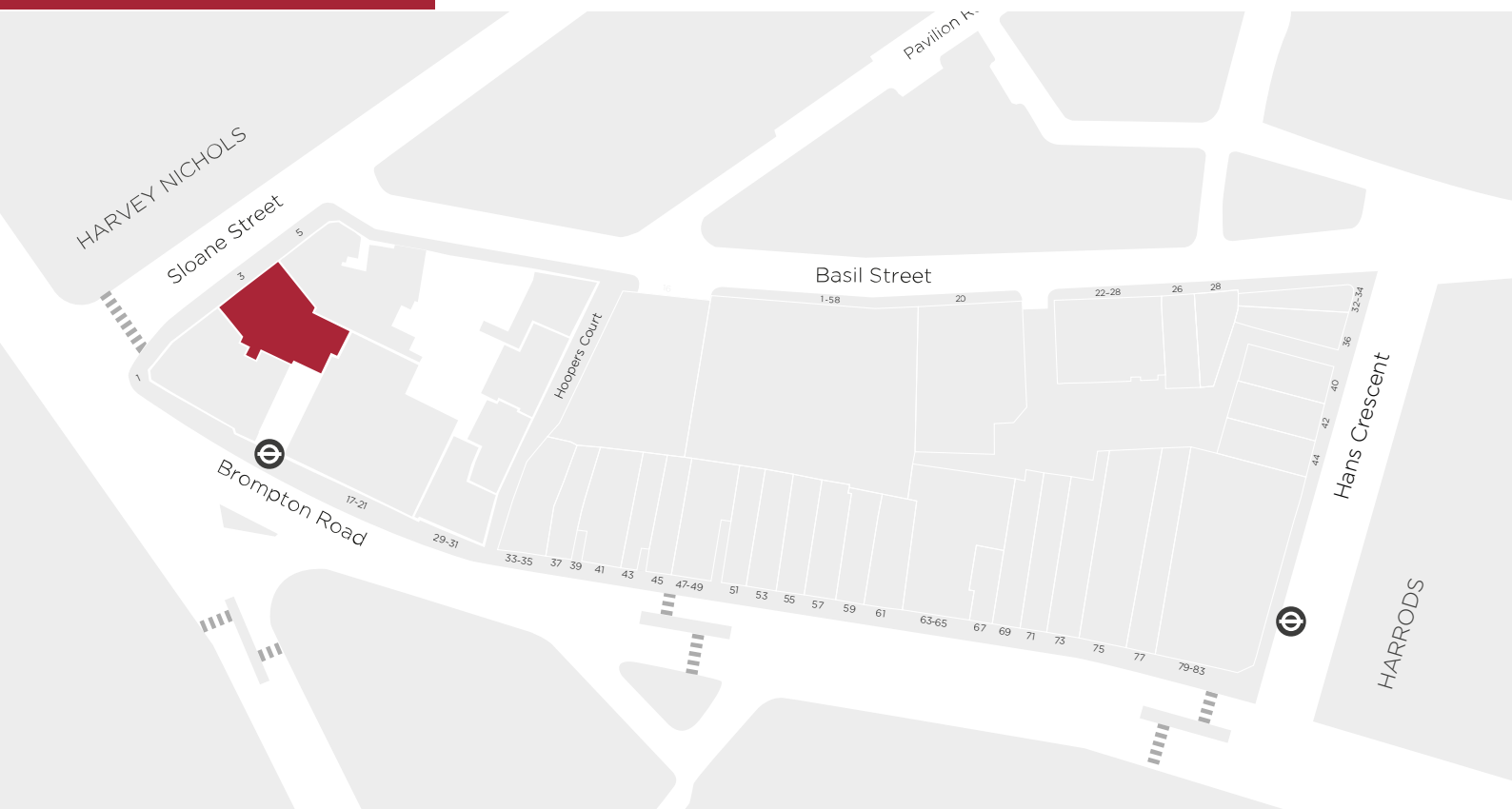

3 Sloane Street

*All floorplans and CGIs are indicative only and subject to design development

TOTAL AREA

11,990 sq ft / 1,113.9 sq m

SECOND FLOOR

2,821 sq ft / 262.1 sq m

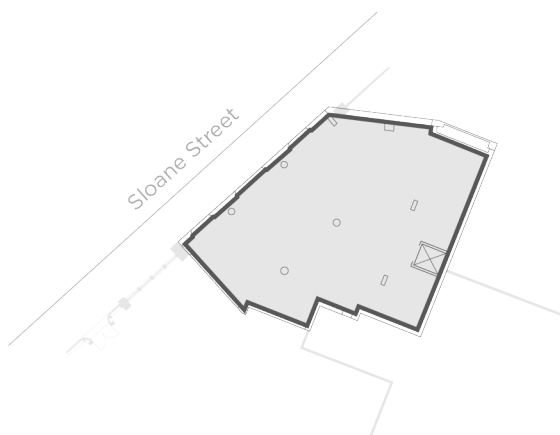

FIRST FLOOR

3,616 sq ft / 335.9 sq m

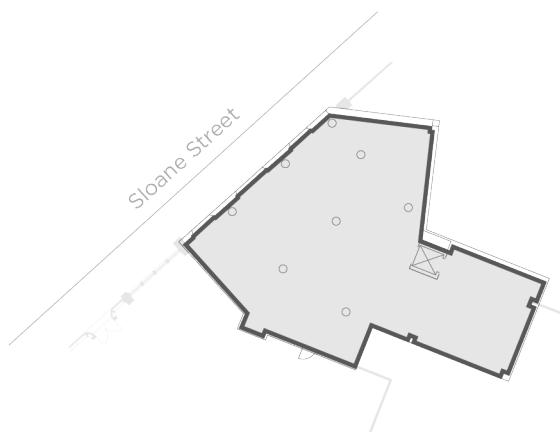

GROUND FLOOR

2,832 sq ft / 263.1 sq m

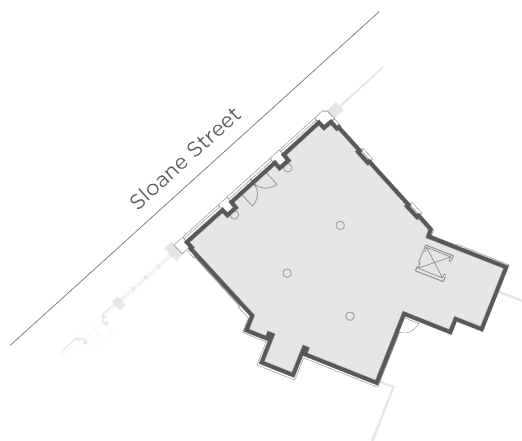

BASEMENT

2,721 sq ft / 252.8 sq m

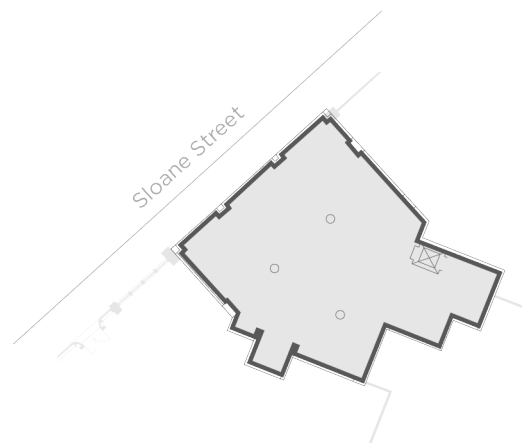



Get in touch

Please contact us to enquire
about the retail unit.

Owned by

OLAVAN[®]

Asset & Development Manager

Chelsfield

CBRE

Steven Stedman

steven.stedman@cbre.com

020 7494 6900



Scott Murdoch

scott.murdoch@cwm.co.uk

020 7182 2000